



Republic of the Philippines
Tourism Infrastructure & Enterprise Zone Authority

July 25, 2021

SUPPLEMENTAL/BID BULLETIN No. G-02-07-21

The Bids and Awards Committee of the Tourism Infrastructure and Enterprise Zone Authority announces the following clarifications relative to the pre-bidding conference for the **Supply, Delivery and Installation of Office Furniture and Modular Partition for the Use of TIEZA Regulatory Office** conducted on July 22, 2021:

- The enclosed Annexes A and B of the Terms of Reference are integral part of the bidding documents.
- Suppliers who purchased the bidding documents can visit the site for actual inspection including the conduct of measurements of the site area, if necessary.
- The bidders shall provide photos of their proposed furniture for reference of the End-user.
- As requested by the Supplier and in consideration of the present situation, the End-user and the Bids and Awards Committee revised the delivery/ completion period of the project from 45 to 60 calendar days upon receipt of the Notice to Proceed.

Please be guided accordingly.

ENGR. NESTOR M. DOMALANTA
Chairperson, Bids and Awards Committee

ANNEX A

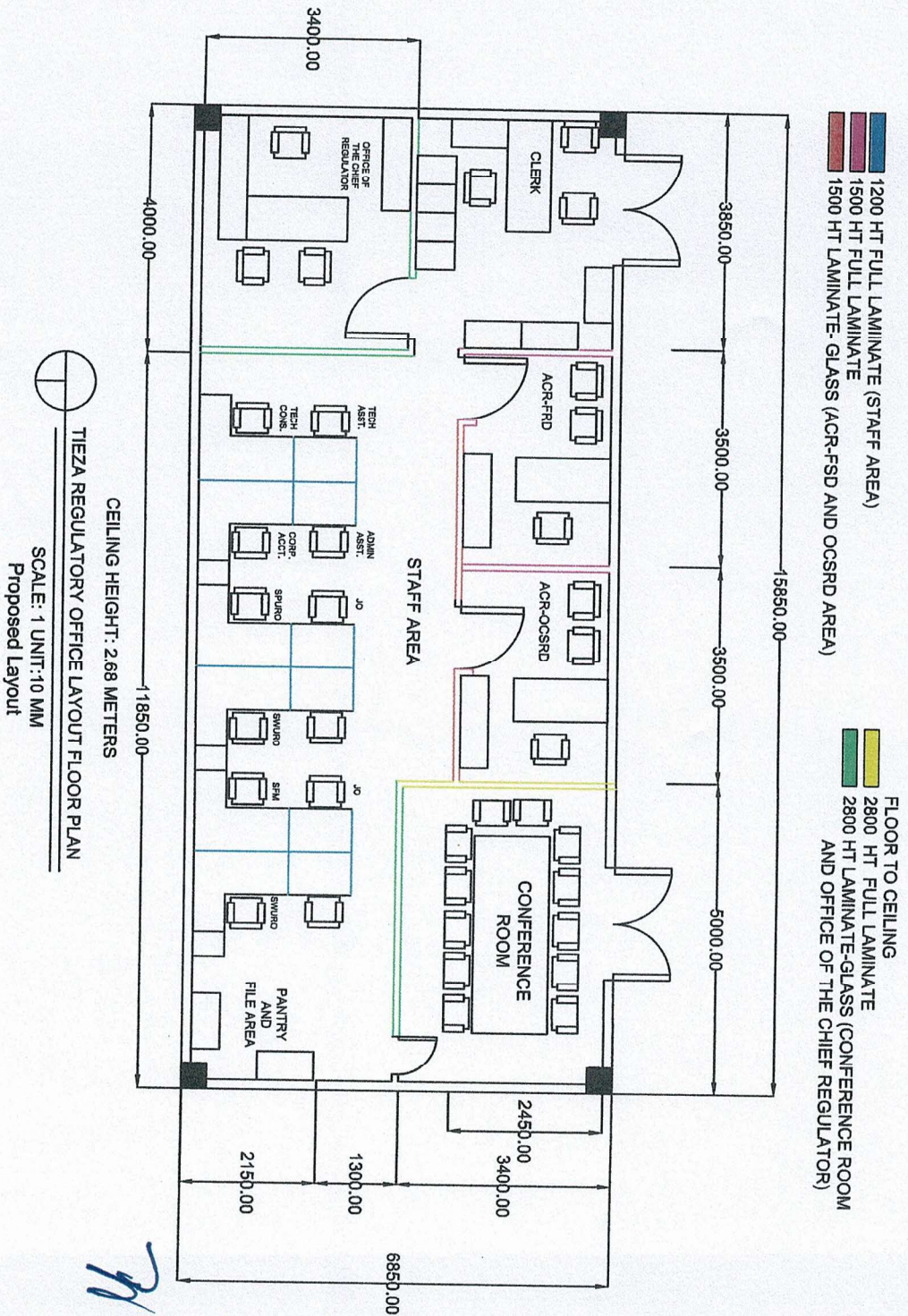

ANNEX B

**PROCUREMENT OF THE SUPPLY AND DELIVERY OF OFFICE FURNITURE AND INSTALLATION OF
OFFICE MODULAR PARTITION**

STAFF AREA

NUMBER OF UNITS	DESCRIPTION	SPECIFICATION
12	1200mm HT cubicle	<ul style="list-style-type: none"> * 468mm Panel thickness * 1200mmHt partition supported on heavy duty levelers * with One(1) raceway at skirting level * Slot for socket of power/data/voice(device not included) * All exposed partition panel edges shall be fixed with aluminum extruded box shape, powder coated trims in two(2) tones fabric finish * Panel edges color: charcoal gray * High Pressure Laminate Finish
12	Workstation / Worktop	<ul style="list-style-type: none"> * 25mm thick board laminated finish * edges in 2mm thick quality PVC edging machine pressed * with grommets for wirings
12	Mobile pedestal	<ul style="list-style-type: none"> * Three(3) drawer metal * 2 pencil and 1 File drawer with pencil tray and file divider * 35cmL x 525cmD x 64cmH * drawer body made up of prime quality 0.80mm thick metal sheet * channels are slide on ball bearings with central lock * 5 casters are provided for free mobility * all steel components should be epoxy powdercoated * color: Charcoal gray
12	Clerical Chair	<ul style="list-style-type: none"> * clerical chair with armrests * mesh/net backrest material * fabric seat * PVC armrests and starbase * with gaslift and caster wheel * Black color
2	3 - layer file cabinet	<ul style="list-style-type: none"> * Three (3) drawer metal * with file divider per drawer * 90cmL x 45cmD x 112cmH * drawer body made up of prime quality 0.80mm thick metal sheet * channels are slide on ball bearings with central lock * with anti tilt safety feature * all steel components should be epoxy powdercoated * color: Charcoal gray

7/

CHIEF REGULATOR'S OFFICE

NUMBER OF UNITS	DESCRIPTION	SPECIFICATION
1	2800mm HT cubicle	<ul style="list-style-type: none"> * 60mm Panel thickness * 2800mmHt partition supported on heavy duty levelers * Tile type at 500mmH per tile. Width varies * with baseboard * all exposed partition panel edges shall be fixed with aluminum extruded box shape, powder coated trims * panel edges color: charcoal gray * Panel finish: Laminate and glass combination * Door panel system integrated with the partition with metal door frame, lever type door knob with key. Fabric finish * Laminate Finish
1	Freestanding Table (D-shaped) with side board cabinet	<ul style="list-style-type: none"> * Freestanding D shaped table with side return * 25mm thick board laminated finish, top and legs * 18mm thick board modesty panel with wire management provision * Side Return cabinet with doors and lock * Woodgrain HPL Laminate Finish * Size: 1.60mL x 0.70mW x 0.75mH / 2.00mL x 0.45mW x 0.675Ht
1	Low Cabinet	<ul style="list-style-type: none"> * woodgrain laminated finish * cabinet top: 25mm thick board * cabinet carcass: 18mm thick board * cabinet swing doors in 18mm thick board * Aluminum handgrab (25mm Thick) with locks * laminated finish with 2mm thick quality PVC edging * size: 1.50m x 0.45m x 0.75H * with adlutable gliders for uneven floor
1	Executive Chair	<ul style="list-style-type: none"> * Highback with armrests * PU Finish-Black * PVC armrests and starbase * with gaslift and caster wheel * Black color
2	Visitor's Chair	<ul style="list-style-type: none"> * Lowback with armrests and casters to match Exec. Chair * PU Finish-Black * PVC armrests and starbase * with gaslift * Black color

CLERK PROCESSOR AREA

NUMBER OF UNITS	DESCRIPTION	SPECIFICATION
1	Workstation	<ul style="list-style-type: none"> * 25mm thick board laminated top and legs * 18mm thick board laminated modesty panel * edges in 2mm thick quality PVC edging machine pressed * provision for wires.provide grommet * Side return: 1.100m x 0.50m x 25mmThk * Size: 1.80mL x 0.70mW
1	Mobile pedestal	<ul style="list-style-type: none"> * Three(3) drawer metal * 2 pencil and 1 File drawer with pencil tray and file divider * 35cmL x 525cmD x 64cmH * drawer body made up of prime quality 0.80mm thick metal sheet * channels are slide on ball bearings with central lock * 5 casters are provided for free mobility * all steel components should be epoxy powdercoated *color: Charcoal gray
1	2 - layer file cabinet	<ul style="list-style-type: none"> * Two(2) drawer metal * with file divider per drawer * 90cmL x 45cmD x 74cmH * drawer body made up of prime quality 0.80mm thick metal sheet * channels are slide on ball bearings with central lock * with anti tilt safety feature * all steel components should be epoxy powdercoated * with 25mm thk board laminated top *color: Charcoal gray
1	Clerical Chair	<ul style="list-style-type: none"> * clerical chair with armrests * mesh/net backrest material * fabric seat * PVC armrests and starbase * with gaslift and caster wheel * Black color
2	Visitors Chair	<ul style="list-style-type: none"> * Stackable-Chrome base * Black Polypropylene seat & back with cushioned seat and back * German Leatherette finish * Cantilevered base
3	MTO-High Cabinet	<ul style="list-style-type: none"> * 0.90mL x 0.45W x 1.80Ht * Base Cabinet 2 shelf with swing door & Lock * Upper Cabinet 3-shelf with glass doors and lock * 18mm Thk MFC Board Woodgrain Finish
5	4 - layer file cabinet	<ul style="list-style-type: none"> * Four (4) drawer metal * with file divider per drawer * 46.5cmL x 62cmD x 140cmH * drawer body made up of prime quality 0.80mm thick metal sheet * channels are slide on ball bearings with central lock * with anti tilt safety feature * all steel components should be epoxy powdercoated *color: Charcoal gray

ASSISTANT CHIEF REGULATOR - OCSRD AREA

NUMBER OF UNITS	DESCRIPTION	SPECIFICATION
1	1500mm HT cubicle	<ul style="list-style-type: none"> * 468mm Panel thickness * 1500mmHt partition supported on heavy duty levelers * with One(1) raceway at skirting level * Slot for socket of power/data/voice(device not included) * all exposed partition panel edges shall be fixed with aluminum extruded box shape, powder coated trims * panel edges color: charcoal gray * Panel finish: Laminate and glass combination * Door panel system integrated with the partition with metal door frame, lever type door knob with key. Fabric finish * High Pressure Laminate Finish
1	Freestanding Table (D-shaped)	<ul style="list-style-type: none"> * Freestanding D shaped table with side return * 25mm thick board laminated finish, top and legs * 18mm thick board modesty panel with wire management provision * woodgrain laminated finish * Size: 1.50mL x 0.75mW
1	Mobile pedestal	<ul style="list-style-type: none"> * Three(3) drawer metal * 2 pencil and 1 File drawer with pencil tray and file divider * 35cmL x 52.5cmD x 64cmH * drawer body made up of prime quality 0.80mm thick metal sheet * channels are slide on ball bearings with central lock * 5 casters are provided for free mobility * all steel components should be epoxy powdercoated * color: Charcoal gray
1	Low Cabinet	<ul style="list-style-type: none"> * woodgrain laminated finish * cabinet top: 25mm thick board * cabinet carcass: 18mm thick board * cabinet swing doors in 18mm thick board * Aluminum handgrab (25mm Thick) with locks * laminated finish with 2mm thick quality PVC edging * size: 1.50m x 0.45m x 0.75H * with adjustable gliders for uneven floor
1	Executive Chair	<ul style="list-style-type: none"> * Highback with armrests * mesh/net backrest material * fabric seat * PVC armrests and starbase * with gaslift and caster wheel * Black color
2	Visitor's Chair	<ul style="list-style-type: none"> * clerical chair with armrests * mesh/net backrest material * fabric seat * PVC armrests and starbase * with gaslift and caster wheel * Black color

ASSISTANT CHIEF REGULATRO - FRD AREA

NUMBER OF UNITS	DESCRIPTION	SPECIFICATION
1	1500mm HT cubicle	<ul style="list-style-type: none"> * 468mm Panel thickness * 1500mm Ht partition supported on heavy duty levelers * with One(1) raceway at skirting level * Slot for socket of power/data/voice(device not included) * all exposed partition panel edges shall be fixed with aluminum extruded box shape, powder coated trims * panel edges color: charcoal gray * Panel finish: Laminate and glass combination * Door panel system integrated with the partition with metal door frame, lever type door knob with key. Fabric finish * High Pressure Laminate Finish
1	Freestanding Table (D-shaped)	<ul style="list-style-type: none"> * freestanding D shaped table with side return * 25mm thick board laminated finish, top and legs * 18mm thick board modesty panel with wire management provision * woodgrain laminated finish * Size: 1.50mL x 0.75mW
1	Mobile pedestal	<ul style="list-style-type: none"> * Three(3) drawer metal * 2 pencil and 1 File drawer with pencil tray and file divider * 35cmL x 52.5cmD x 64cmH * drawer body made up of prime quality 0.80mm thick metal sheet * channels are slide on ball bearings with central lock * 5 casters are provided for free mobility * all steel components should be epoxy powdercoated * color: Charcoal gray
1	Low Cabinet	<ul style="list-style-type: none"> * woodgrain laminated finish * cabinet top: 25mm thick board * cabinet carcass: 18mm thick board * cabinet swing doors in 18mm thick board * Aluminum handgrab (25mm Thick) with locks * laminated finish with 2mm thick quality PVC edging * size: 1.50m x 0.45m x 0.75H * with adlustable gliders for uneven floor
1	Executive Chair	<ul style="list-style-type: none"> * Highback with armrests * mesh/net backrest material * fabric seat * PVC armrests and starbase * with gaslift and caster wheel * Black color
2	Visitor's Chair	<ul style="list-style-type: none"> * clerical chair with armrests * mesh/net backrest material * fabric seat * PVC armrests and starbase * with gaslift and caster wheel * Black color

Handwritten signature/initials

CONFERENCE ROOM

NUMBER OF UNITS	DESCRIPTION	SPECIFICATION
1	2800mm HT cubicle	<ul style="list-style-type: none"> * 60mm Panel thickness * 2800mmHt partition supported on heavy duty levelers * Tile type at 500mmH per tile. Width varies * fabric finish * with baseboard * all exposed partition panel edges shall be fixed with aluminum extruded box shape, powder coated trims * panel edges color: charcoal gray * Panel finish: Laminate and glass combination * Door panel system integrated with the partition with metal door frame, lever type door knob with key. Fabric finish * Laminate Finish
1	Conference Table	<ul style="list-style-type: none"> * Freestanding Boat shaped table * 30mm thick board laminated finish, top and legs * 18mm thick board modesty panel with flip up wire management provision * 12-seater * Size: 3.20mL x 1.20mW x 0.75mH
12	Conference Chair	<ul style="list-style-type: none"> * Highback and Midback with armrests * mesh/net backrest material * fabric seat * PVC armrests and starbase * with gaslift and caster wheel * Black color

Handwritten signature/initials

**PROCUREMENT OF THE SUPPLY AND DELIVERY OF OFFICE
FURNITURE AND INSTALLATION OF OFFICE MODULAR PARTITION**

BID FORM

STAFF AREA

NUMBER OF UNITS	DESCRIPTION (as per Technical Specifications)	UNIT PRICE	TOTAL COST
12	1200mm HT cubicle		
12	Workstation / Worktop		
12	Mobile pedestal		
12	Clerical Chair		
2	3 - layer file cabinet		

CLERK PROCESSOR AREA

NUMBER OF UNITS	DESCRIPTION		
1	Workstation		
1	Mobile pedestal		
1	2 - layer file cabinet		
1	Clerical Chair		
2	Visitors Chair		
3	MTO-High Cabinet		
5	4 - layer file cabinet		

ASSISTANT CHIEF REGULATOR - FRD AREA

NUMBER OF UNITS	DESCRIPTION		
1	1500mm HT cubicle		
1	Freestanding Table (D-shaped)		
1	Mobile pedestal		
1	Low Cabinet		
1	Executive Chair		
2	Visitor's Chair		

Sub-Total

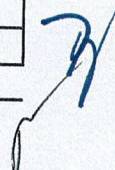

ASSISTANT CHIEF REGULATOR - OCSR D AREA

NUMBER OF UNITS	DESCRIPTION		
1	1500mm HT cubicle		
1	Freestanding Table (D-shaped)		
1	Mobile pedestal		
1	Low Cabinet		
1	Executive Chair		
2	Visitor's Chair		

CHIEF REGULATOR'S OFFICE

NUMBER OF UNITS	DESCRIPTION		
1	2800mm HT cubicle		
1	Freestanding Table (D-shaped) with side board cabinet		
1	Low Cabinet		
1	Executive Chair		
2	Visitor's Chair		

CONFERENCE ROOM

NUMBER OF UNITS	DESCRIPTION		
1	2800mm HT cubicle		
1	Conference Table		
12	Conference Chair		
GRAND TOTAL			

